

France:
Commercial info

0 820 822 822

Technical info

0 820 200 045

fax

0 820 820 191

DELTA DORE TALCO - Bonnemain - 35270 COMBOURG
E-mail: deltadore@deltadore.com
pro.deltadore.com

España:

DELTA DORE ELECTRÓNICA, S.A
C/ Antoni Borja, 13
Semi-sótano, local 1 y 2 - 08191 Rubí (Barcelona)
Tlf.: 93 699 65 53 - Fax.: 93 588 19 66
E-mail: deltadore@deltadore.es
www.deltadore.es

Deutschland:

DELTA DORE Schlüter GmbH
Fichtenstraße 38 a
D - 76829 Landau
Telefon: 0049 7276 96690 - Telefax: 07276 502120
Email: info@delta-schlueter.de



Device complying with the requirements of the
R&TTE 1999/5/EC directive



TYXIA 253

Centralised control unit for control systems

Ref.: 6351034



Installation and use



2701473 Rev.1



Presentation

Tyxia 253 is a centralized control for X2D roller blind receivers (or other X2D control systems).

Tyxia 253 is used to:

- control the raising or lowering of 4 groups or all  of your shutters.
- activate or deactivate the 24 hour repetition of 4 groups or all  of your 24 hour repetitions.
- switch on 2 scenarios.

For use with the lighting:

- the ▲ button controls the switching on.
- the ▼ button controls the switching off.

Because of changes in standards and equipment, the characteristics given in the text and the illustrations of this document are not binding unless confirmed by Delta Dore.

Contents

Description	p 4
Installation	p 5
Starting up	
Power supply.....	p 6
Enter association mode	p 6
Associate raise/lower receivers.....	p 7
Associate the repetition of	
the raise or lower operation	p 8
Create a scenario	p 9
Exit the association mode.....	p 9
Remove the associations	p 10
Use	
Activate the raise or lower operation	p 12
Activate or deactivate the repetition.....	p 12
Starting up a scenario	p 13
Characteristics.....	p 14
Questions / Answers	p 15

Description

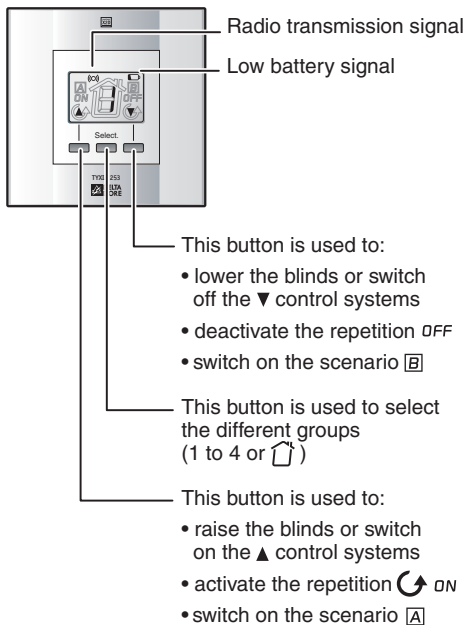

Installation

Wall-mounted or placed on accessible furniture at a height of 1.50 m.

Installation precautions for correct transmission

In dwellings, the propagation of radio waves is reflected and attenuated by the structures encountered. This propagation can be altered, so avoid installing products near large metal masses (beams) or an electrical switchboard.

It is advisable to test the radio transmission with the X2D receivers before finally installing the transmitter.

Wall mounting

Remove the TYXIA 253 from its support **1** **2**. Using the flat screwdriver, unclip **3** then remove the cover **4**, then the batteries **5** to access the mounting holes **6**.

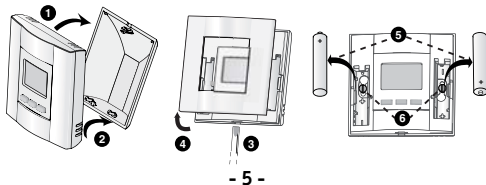

Starting up

Power supply

Using a flat screwdriver, unclip **1** then remove the cover **2**.

Remove the battery tab **3**, then fit the cover back.

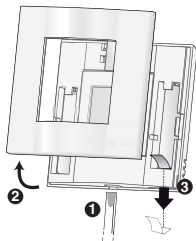

Enter the association mode

Press **Select.** until the display flashes (~5 sec.).

If you want to select another group (1 to 4 or ) , briefly press the **Select.** button.

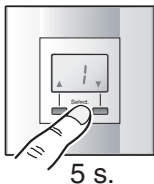



Note: After 2 minutes without any button being pressed, the TYXIA 253 automatically exits the association mode.

Associate raise/lower receivers

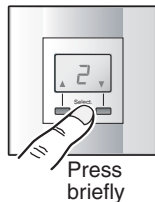
On the TYXIA 253, briefly press the Select. button, to **select.** a raise / lower group (1 to 4 or ). Example: group 2.



On each of the receivers that you want to associate with group 2, simultaneously press on  and  buttons until the LED switches on. Release.

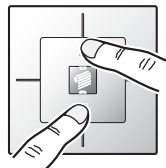

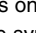
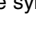
On the TYXIA 253, press one of the  or  buttons, the symbols become steady.



Check that the LED of each receiver is no longer flashing.

Starting up

Associate the repetition of the raise or lower operation

If you want to activate or deactivate the repetition of a group of roller blinds, choose the same group number as the one assigned when associating the receivers for the raise / lower operation.

Example: associate the receivers of the raise / lower group 1 on the repetition group 1.

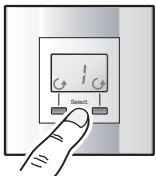
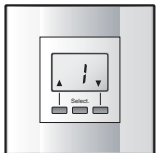

Receivers associated with the raise / lower group 1

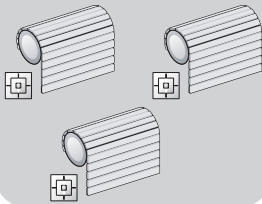

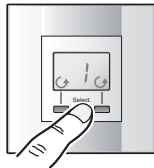

Note: You must associate the TYXIA 253 with the receivers, before choosing the time for the raise or lower operation of your blinds (see receiver instructions).

On the TYXIA 253, briefly press the **Select** button, to select a repetition group (1 to 4 or .

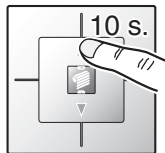

On each of the receivers that you want to associate with the repetition group, press Δ for the repetition of the raise action and/or ∇ for the repetition of the lower action until the LED flashes.



On the TYXIA 253, press one of the  buttons, the symbols become steady. Check that the LED of each receiver is no longer flashing.

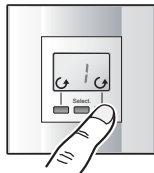

Starting up

Create a scenario

On the TYXIA 253, briefly press the **Select.** button to select the association screen for a scenario.

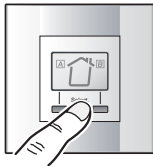

Set the receiver(s) to the required state (blinds lowered, lights on at 70%, etc.). Next, set the receiver(s) to association mode (see their respective instructions).

Via an X20 receiver

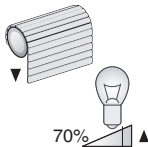

On the TYXIA 253, press the scenario **A** or **B** scenario button.

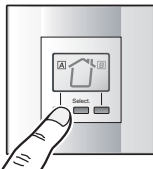

Check that the LEDs of the receivers are no longer flashing.

Exit the association mode

Press the **Select.** button for 5 sec.

Remove the associations

Remove an association group or a scenario

On the TYXIA 253, press the **Select.** button until the display flashes (~5 sec.).

Then briefly press the **Select.** button to select the group or scenario to remove. Then press one of the buttons **▲**, **▼**, **↻**, **A** or **B** for 5 seconds.

On each receiver of the group, press and hold the association button(s) of the receiver (the LED flashes after 3 seconds). Keep it pressed down until the LED extinguishes to confirm that all the receiver associations are deleted.

On the TYXIA 253, select another group to remove or press the **Select.** button for 5 seconds to exit the association mode.

Remove the associations

Remove all the association groups

On the TYXIA 253, press the **Select.** button until the display flashes (~5 sec.).

Then, from group that has already been associated, press one of the ▲, ▼, ↻, [A] or [B] buttons for 30 seconds.

At the end of the 30 seconds, the raise ▲ /lower ▼ group 1 displays steady on the screen.

On each receiver, press and hold the association button(s) of the receiver (the LED flashes after 3 seconds). Keep it pressed down until the LED extinguishes to confirm that all the receiver associations are deleted.

Use

During use, only associated groups or scenarios will be proposed.

Activate the raise or lower operation

With the **Select.** button, select the raise/lower group of your choice. Then press the ▲ or ▼ button.

Example:

Lower the roller blinds associated with group 2.

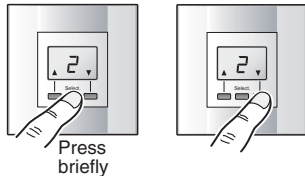

Activate or deactivate the repetition

With the **Select.** button, select the ↻ repetition group of your choice.

Next, press the **ON** button to activate or the **OFF** button to deactivate the repetition.

Starting up a scenario

With the **Select.** button, select the screen corresponding to the scenarios, then press the button of the scenario of your choice [A] or [B].

Characteristics

- Power supply: two 1.5V, LR03 alkaline batteries
- Autonomy: approximately 2 years
- Transmission frequency: 868 MHz, class I (standard EN 300 220)
- Radio range 100 to 300 metres outside depending on the associated equipment (the range can be altered depending on the installation conditions and the electromagnetic environment)
- Protection index: IP30
- Storage temperature: -10°C to +70°C
- Operating temperature: 0°C to 40°C
- Dimensions: 80 x 80 x 23 mm
- Installation in an environment with normal pollution levels
- Radio remote control device

Questions / Answers

In the same group, one of the blinds lowers or raises 10 seconds after the other blinds.

➡ A recycling command was given 10 seconds later to ensure that all the receivers had received the order.

The battery symbol is displayed.

➡ The batteries are low.

In the association mode, on some screens, the symbols ▲, ▼, ↻, [A] or [B] do not flash.

➡ Receivers are already associated with these screens.